

THIS DRAWING IS SUPPLIED FOR INFORMATION ONLY. DESIGN FEATURES, SPECIFICATIONS AND PERFORMANCE DATA SHOWN HEREON ARE THE PROPERTY OF THE AMPHENOL CORPORATION. NO RIGHTS OF REPRODUCTION ARE IMPLIED. ALL DIMENSIONS ARE SUBJECT TO NORMAL MANUFACTURING VARIATIONS.

REVISIONS						
REV	ZONE	ECO	DESCRIPTION	DATE	BY	APPR
A	---	---	INITIAL RELEASE	09/20/18	FL	JL
B	---	---	add new applicable terminals	01/16/19	FL	JL
C	---	---	Add plating type information of terminal and attention information	04/29/20	FL	JL
D	---	ECNG220404	Add plating type information of terminal	06/09/22	RJ	JL

Customer Drawing

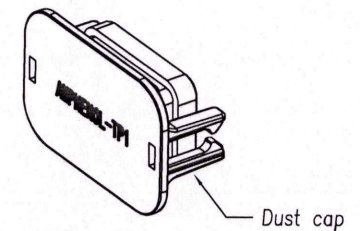
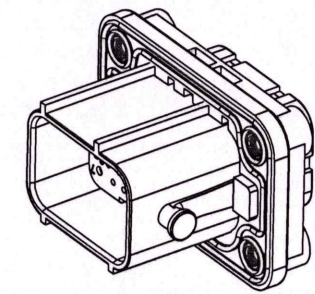
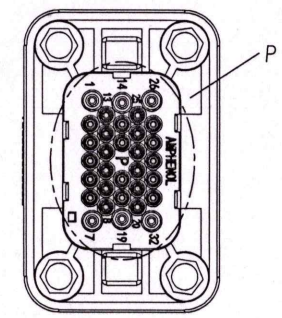
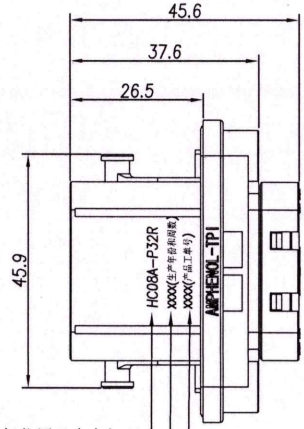
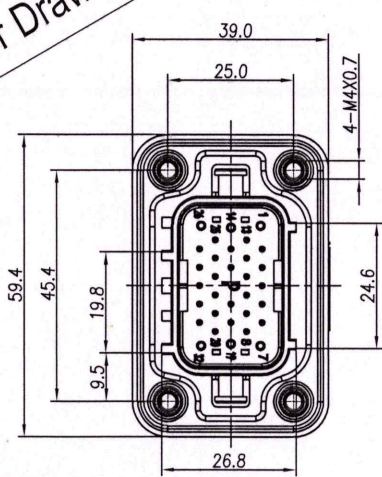

Amphenol TPI
2022-06-10
REGISTERED COPY

激光打标位置及内容如下:
HC08A-P32R
XXXX(生产年份和周数)
XXXX(产品工单号)

- 安装面板要求:
1. 厚度不超过6.5mm
加上螺丝头厚度不超过8mm
 2. 平面度要求0.15mm
 3. 表面粗糙度Ra3.2

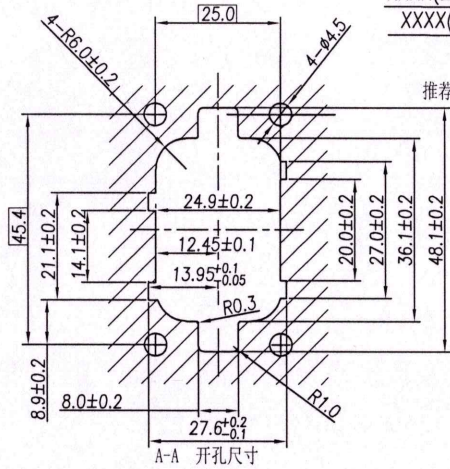

推荐面板开孔方向

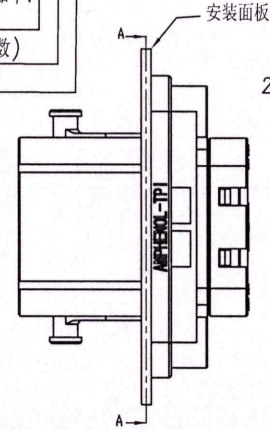

6 X Power
26 X Signal

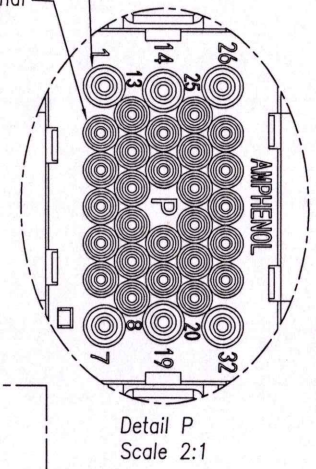

订购信息 Ordering Information

HC08 A - P32 R

键位 Key: "A" orange
安装类型 installation type: R, 法兰后 Rear the flange

- 规格参数 (Spec.):
1. 工作温度 Operating Temperature: -40° C ~ +125° C.
 2. 额定电流 Current Rating:
Power: 13 A MAX.
Signal: 5 A MAX.
 3. 配对线径 Cable Size:
3.1. Power: 14~18 AWG.
3.2. Signal: 20~22 AWG.
 4. 耐电压 Dielectric Withstanding Voltage: 3000 VDC.
 5. 防护等级 Protection Class: IP68 (接头对配时 Mated connector).
 6. 机械寿命 Mating Cycle: 100 Min.
 7. 法兰盘螺丝安装扭矩
Screw Assembly Torque on Flange: 1.6~2.4 Nm
 8. 对配插头见图纸 Mating plug see drawing: "HC18A-S32"
 9. 防火等级 Flame Class: UL94V-0 ▽

注意: 镀金端子不能与镀锡端子互配。划掉的端子料号2022年10月1日起停产。
Note: The gold-plated terminal cannot be matched with the tin-plated terminal.
The terminal material number crossed out will be discontinued from October 1, 2022.

适用端子型号 Used with terminal NO.						
端子种类 Terminal type	端子料号 Terminal P/N	电镀种类 Plating type	适合电线 Wire range	导线外径范围 电线外径范围	盲堵种类 Seal type	盲堵料号 Seal P/N
16# (Power)	HCTM2140†	镀底镀金 Flash Gold	14-18 AWG	2.24~3.00mm	16# (Power)	AC-CP000383
	HCTM2150†	镀底镀锡 Tin Plated				
	HCTM2160†	镀底镀金 Flash Gold				
	HCTM1616†	镀底镀锡 Flash Gold				
	HCTM1616†	镀底镀锡 Tin Plated				
20# (Signal)	HCTM1200†	镀底镀金 Flash Gold	20~22 AWG	1.35~2.50mm	20# (Signal)	AC-CP000382
	HCTM1210†	镀底镀锡 Tin Plated				
	HCTM2010†	镀底镀金 Flash Gold				
	HCTM2010†	镀底镀锡 Tin Plated				

		Amphenol Technical Products International GZ				
		第三角投影 THIRD ANGLE PROJECTION	页面 SHEET 1 of 2	幅面 SIZE A3	版次 REV. D	比例 SCALE
签名 SIGNATURE RJ	日期 DATE 06/09/22	UNLESS OTHERWISE SPECIFIED 1) All dimensions are in metric(mm). 2) Tolerances are as follows: 0 PL DEC ±1.00 1 PL DEC ±0.50 2 PL DEC ±0.20 Angles ±1°			DWG NO: HC08A-P32R	
制图 DRAWN RJ	审核 CHECKED RJ	批准 APPROVAL RJ	CUSTOMER PART #: N/A			CUSTOMER REV.: -

THIS DRAWING IS SUPPLIED FOR INFORMATION ONLY. DESIGN FEATURES, SPECIFICATIONS AND PERFORMANCE DATA SHOWN HEREON ARE THE PROPERTY OF THE AMPHENOL CORPORATION. NO RIGHTS OF REPRODUCTION ARE IMPLIED. ALL DIMENSIONS ARE SUBJECT TO NORMAL MANUFACTURING VARIATIONS.

Customer Drawing

REVISIONS						
REV	ZONE	ECO	DESCRIPTION	DATE	BY	APPR
A	---	---	INITIAL RELEASE	09/20/18	FL	JL
B	---	---	add new applicable terminals	01/16/19	FL	JL
C	---	---	Add plating type information of terminal and attention information	04/29/20	FL	JL
D	---	ECN0220404	Add plating type information of terminal	06/09/22	RJ	JL

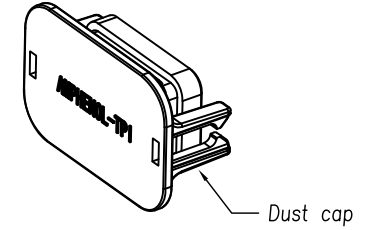
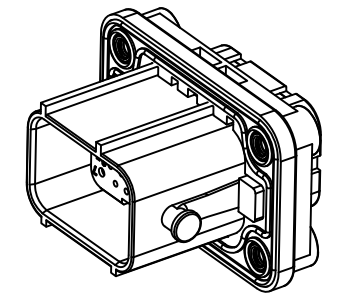
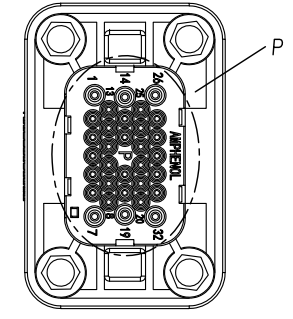
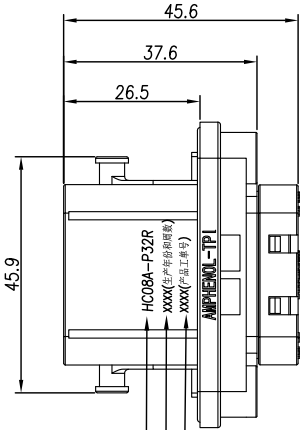
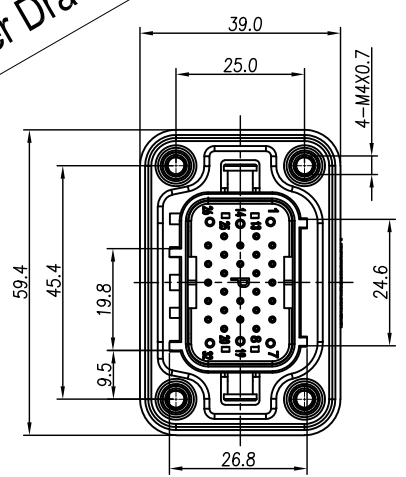

激光打标位置及内容如下:
 HC08A-P32R
 XXXX(生产年份和周数)
 XXXX(产品工单号)

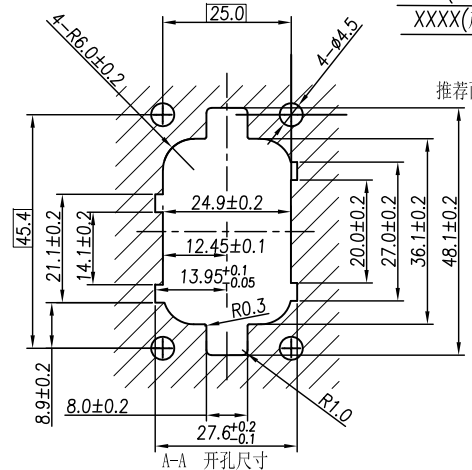

推荐面板开孔方向

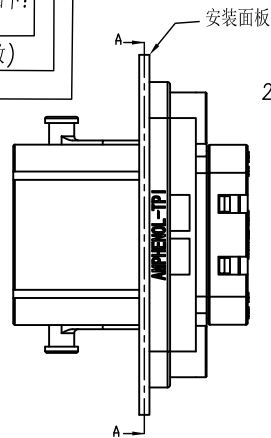

6 X Power
 26 X Signal

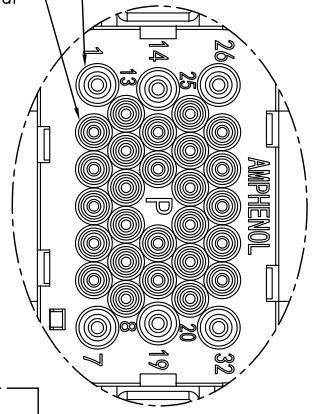

Detail P
 Scale 2:1

- 规格参数 (Spec.):
- 工作温度 Operating Temperature: -40° C~+125° C.
 - 额定电流 Current Rating:
 Power: 13 A MAX.
 Signal: 5 A MAX.
 - 配对线径 Cable Size:
 3.1. Power: 14~18 AWG.
 3.2. Signal: 20~22 AWG.
 - 耐电压 Dielectric Withstanding Voltage: 3000 VDC.
 - 防护等级 Protection Class: IP68 (接头对配时 Mated connector).
 - 机械寿命 Mating Cycle: 100 Min.
 - 法兰盘螺丝安装扭矩
 Screw Assembly Torque on Flange : 1.6~2.4 Nm
 - 对配插头见图纸 Mating plug see drawing: "HC18A-S32"
 - 防火等级 Flame Class: UL94V-0

- 安装面板要求:
- 厚度不超过6.5mm
 加上螺丝头厚度不超过8mm
 - 平面度要求0.15mm
 - 表面粗糙度Ra3.2

订购信息 Ordering Information

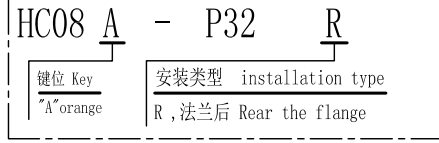

注意: 镀金端子不能与镀锡端子互配。划掉的端子料号2022年10月1日起停产。
 Note: The gold-plated terminal cannot be matched with the tin-plated terminal.
 The terminal material number crossed out will be discontinued from October 1, 2022.

适用端子型号 Used with terminal NO.						
端子种类 Terminal type	端子料号 Terminal P/N	电镀种类 Plating type	适合电线 Wire range	Wire OD range 电线外径范围	盲堵种类 Seal type	盲堵料号 Seal P/N
16# (Power)	HCTM21401	镀底镀金 Flash Gold	16~18 AWG	2.24~3.00mm	16# (Power)	AC-CP000383
	HCTM21504	镀底镀锡 Tin Plated				
	HCTM21601	镀底镀金 Flash Gold				
	HCTM16161	镀底镀金 Flash Gold				
	HCTM16164	镀底镀锡 Tin Plated				
20# (Signal)	HCTM12001	镀底镀金 Flash Gold	20~22 AWG	1.35~2.50mm	20# (Signal)	AC-CP000382
	HCTM2104	镀底镀锡 Tin Plated				
	HCTM20101	镀底镀金 Flash Gold				
	HCTM20104	镀底镀锡 Tin Plated				

Amphenol Technical Products International GZ

第三角投影 THIRD ANGLE PROJECTION	页面 SHEET	幅面 SIZE	版次 REV.	比例 SCALE	PART NAME: HC 32CKT Rcpt Rear Code A
1 or 2	A3	D			
签名 SIGNATURE		日期 DATE		UNLESS OTHERWISE SPECIFIED	
制图 DRAWN		06/09/22		1) All dimensions are in metric (mm).	
审核 CHECKED		06/09/22		2) Tolerances are as follows:	
批准 APPROVAL		06/09/22		1 PL DEC ±1.00	
				2 PL DEC ±0.50	
				Angles ±1°	
DWG NO: HC08A-P32R					CUST REV. -

Key Characteristics
 Contact Amphenol for Latest Definition
 Critical 关键特性
 Significant 重要特性